

This is a basic guide to creating rough scenic areas showing some simple techniques to produce some of the planting that is likely to be found in such an area.

Materials used

- AT00005 - Masking tape 3M/Scotch 25mmx50m
- AG00008 - Flock adhesive 250ml (green)
- LG20022 - Flock - Grass mix 22g
- AP00031 - PVA glue 170ml
- LG30015 - Green scene Turned earth 116
- LG30073 - Texture mid green 100cc L23
- LG30074 - Texture dark green 100cc L24
- LG60002 - Texture mat light green 75x150
- LG60003 - Texture mat mid green 75x150
- LG40401 - 1:45 Calcareous tufts summer
- LT50001 - Lichen green, Green Scene 313
- LT11075 - Deciduous green tree etched 75mm
- LT17075 - Silver Birch tree etched 75mm
- LT15175 - Deciduous cork tree etched 175mm



Applying grass flock

Mask out the areas that are not to be flocked with a good masking tape then paint the grass areas with flock adhesive using a paint brush. Sieve the flock over the flock adhesive and allow to dry, ideally over night then knock off the excess flock.



Woodland path

Paint pva glue onto the brown speckled path then sprinkle turned earth texture onto it. Allow to dry for at least 30 minutes then knock off the excess texture.

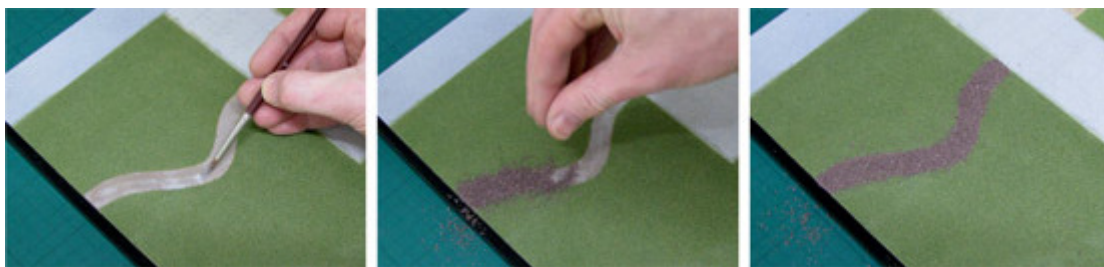

Adding rough grass

Glue mid and dark green texture in clumps with pva to create the rough grassed areas. Then for low lying shrubs tease out pieces of the light and mid green texture mats and glue down with pva glue to add rougher areas and low lying shrubs.



Adding long grass

Remove a tuft from the backing sheet with a pair of tweezers. Paint a blob of PVA glue to the base of the tuft and glue into place.



Adding Small Bushes

Take pieces of lichen and cut with scissors to the correct size for the model then glue in place the PVA glue to add height and to represent shrubs and bushes.



Adding trees

Add some different types of trees to give more height and variety to the planting. Drill a planting hole in the base board and glue into place with PVA glue.



Detail of the finished model showing the path and planting

Creative Materials for Creative Minds